



Nine Mile Creek Discovery Point

12800 Gerard Drive

Eden Prairie, MN 55346

(952) 835-2078

www.ninemilecreek.org

MEMO

TO: Nine Mile Creek Board of Managers
FROM: Erica Sniegowski
DATE: February 15, 2019
RE: Clean Water Fund/Master Water Steward Projects

Background

A Clean Water Fund (CWF) Accelerated Implementation Grant was awarded to the District in 2017. The outcome of the grant was to have preliminary design plans and cost estimates prepared for stormwater best management practices (BMPs) on prioritized, non-profit sites, so the District could pursue project installation.

CWF Acceleration Implementation Fund Grant Outcomes

58 parcels in the watershed were identified during a GIS desktop site analysis that had nonprofit status and met criteria for in-person site visits.

Over four days in July and August 2017, District staff and Barr Engineering staff visited 58 nonprofit sites in the watershed to assess suitability for BMPs at the sites. 21 locations and 24 BMPs were identified. The locations and BMPs were then screened using a prioritization tool and given a grade to guide outreach efforts.

Fifteen nonprofits were selected for outreach, which was later expanded to seventeen based on previous work with two organizations. Eight in person meetings were set up based on phone and email outreach. For the meetings, high level concept plans and a handout were provided to explain the goals of the project, responsibilities, and the process moving forward.

In order to gain commitment to install a BMP from the nonprofit organizations, the District committed to 100% fund the BMP installation and complete the first two years of maintenance on the project. The partner organization agreed to have a 15-year maintenance agreement on the project and maintain the project for the remaining time period. Based on the outreach meetings, the District received commitments from six churches to move forward with projects. The six churches and projects were:

1. Bethlehem Lutheran Church (5701 Eden Prairie Rd, Minnetonka, MN 55345): Infiltration Basin
2. Chapel Hills United Church of Christ (6512 Vernon Ave S, Edina, MN 55436): Vegetated Swale
3. Good Samaritan United Methodist Church (5730 Grove St, Edina, MN 55436): Raingarden
4. The Church of St. Edward (9401 Nesbitt Ave S, Bloomington, MN 55437): Two Raingardens
5. Oak Grove Presbyterian Church (2200 W Old Shakopee Rd, Bloomington, MN 55431): Raingarden
6. St. Luke's Lutheran Church (1701 W Old Shakopee Rd, Bloomington, MN 55431): Raingarden

Following the commitments from the organizations, Bar Engineering did site surveys and utility locates and created preliminary BMP design plans. District and Barr staff met again with the organizations to review the BMP design plans and responsibilities required for the projects.

A Projects and Practices CWF grant was submitted to the Board of Water and Soil Resources in August 2018. The District was notified in December that it did not receive funding for the implementation of the projects. Additionally, a Hennepin County Opportunity grant was submitted to the county in December 2018, which the District also did not receive.

Next Steps

For the District to fund and implement these projects (oversee contracting and construction), the projects must be included in the District's water management plan. This requires a minor plan amendment (including a public comment period and public hearing to hear and address received comments). A budget amendment will also need to occur to use existing funds in the 2019 budget to implement three of the six projects this year. The District could budget for the remaining three projects in 2020.

Master Water Steward Connection

We have four master water stewards (2 stewards from previous years and 2 stewards from the current cohort) that staff would like to connect with three of the projects. They would use the projects to complete their capstone requirements. The focus of their work would be on education at the partner organizations, while being mentored on project design and implementation. They would also take a role in the maintenance of the projects.

Recommendation

Discuss if the Board feels it is appropriate, direct staff to draft and issue a minor plan amendment for the required 30 day comment period and set a date to hold a public hearing on the amendment and potentially order the projects.

Attachments: Example Project Documents

- Oak Grove's Concept Plan
- Oak Grove's Preliminary BMP Design



Rain Garden with massings of ornamental grasses and shrubs.



Simple planting of sedges with native shrubs along edge. Flowering plants can be added but require additional maintenance.

Oak Grove Presbyterian Church

Concept Plan for Proposed Rain Garden 4/20/2018

- KEY
- Area to be Surveyed
 - Parcel
 - ➔ Overland Movement of Stormwater



CADD USER: Bill M. Brohman FILE: I:\DESIGN\23270634\002018\OAK GROVE\23270634.00 - C-01.DWG PLOT SCALE: 1:12 PLOT DATE: 9/28/2018 12:31 PM
 BARR:\AutoCAD 2011\AutoCAD 2011\Support\enu\Template\Barr_2011_Template.dwt Plot at 1: 10/05/2010 14:03:50

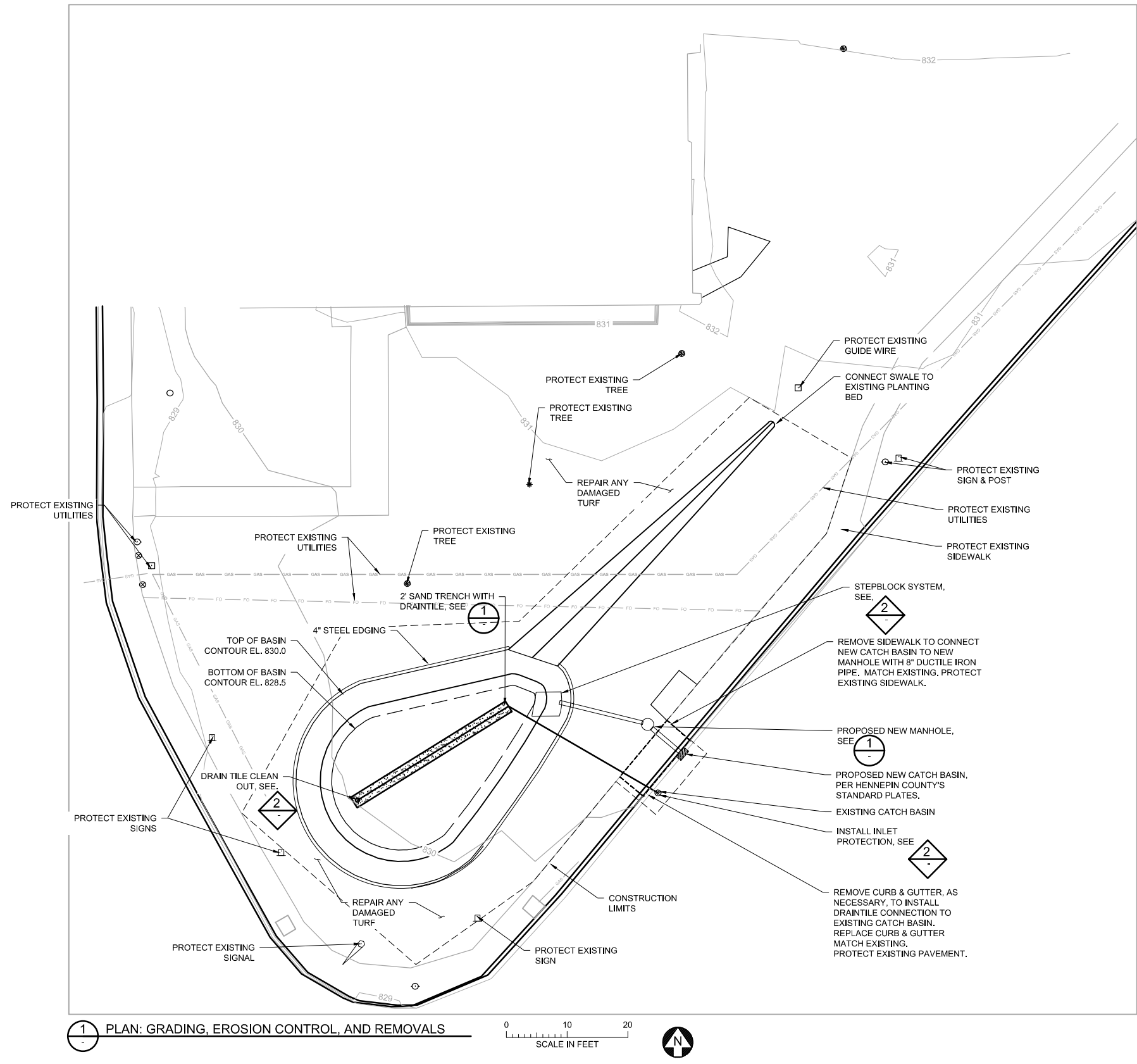

- SAND TRENCH
- POWER POLE
- LIGHT POLE
- SIGN POST
- DECIDUOUS TREE
- CONIFEROUS TREE
- SANITARY MANHOLE
- BACK OF CURB LINE
- FLOW LINE
- GAS LINE
- FIBER OPTIC LINE
- MAJOR CONTOUR
- MINOR CONTOUR
- PROPOSED MAJOR CONTOUR
- PROPOSED MINOR CONTOUR

- NOTES:
- NO WORK SHALL OCCUR WHILE CHILDREN ARE PRESENT
 - POTHOLE ALL EXISTING UTILITIES LOCATED WITHIN THE PROJECT LIMITS BEFORE EARTHWORK BEGINS.
 - MAKE ARRANGEMENTS FOR THE OWNER'S REPRESENTATIVE TO BE ONSITE WHILE SAND TRENCHES ARE EXCAVATED AND SUBGRADE SOILS ARE LOOSENING.
 - NO RUBBER TIED EQUIPMENT IN BASIN AFTER LOOSENING. LOW GROUND PRESSURE TRACKED EQUIPMENT ONLY.
 - ANY COMPACTION OF PREVIOUSLY LOOSENING SOIL MUST BE RELOOSENING.
 - THE CONTRACTOR SHALL HAVE ACCESS TO STREET SWEEPING EQUIPMENT AT ALL TIMES. THE CONTRACTOR SHOULD BE AWARE OF WEATHER CONDITIONS AND SWEEP ANY STREETS WITH DEBRIS PRIOR TO ANY RAINFALL EVENT. STOCKPILING ON THE STREET DURING ANY RAINFALL EVENT SHALL NOT BE ALLOWED.
 - COORDINATE WITH OWNER TO ENSURE ACCEPTABLE TRAFFIC CONTROL REQUIREMENTS.
 - SOD DISTURBANCE SHALL BE CONFINED TO THE CONSTRUCTION LIMITS, AND ANYTHING OUTSIDE THE CONSTRUCTION LIMITS WILL BE REPAIRED BY THE CONTRACTOR.

1 PLAN: GRADING, EROSION CONTROL, AND REMOVALS
 SCALE IN FEET 0 10 20

PRELIMINARY DRAFT

				I HEREBY CERTIFY THAT THIS PLAN, SPECIFICATION, OR REPORT WAS PREPARED BY ME OR UNDER MY DIRECT SUPERVISION AND THAT I AM A DULY LICENSED LANDSCAPE ARCHITECT UNDER THE LAWS OF THE STATE OF MINNESOTA. PRINTED NAME _____ SIGNATURE _____ DATE _____ LICENSE # _____				CLIENT BID CONSTRUCTION RELEASED TO/FOR DATE RELEASED				 Project Office: BARR ENGINEERING CO. 4300 MARKETPOINTE DRIVE Suite 200 MINNEAPOLIS, MN 55435 Corporate Headquarters: Minneapolis, Minnesota Ph: 1-800-632-2277 Fax: (952) 832-2601 www.barr.com				Scale AS SHOWN Date 9/28/2018 Drawn WMB Checked _____ Designed WMB Approved _____				NINE MILE CREEK WATERSHED DISTRICT EDEN PRAIRIE, MN				OAK GROVE PRESBYTERIAN CHURCH BLOOMINGTON, MN				BARR PROJECT No. 2327634.00 CLIENT PROJECT No.			
NO. BY CHK. APP. DATE REVISION DESCRIPTION												GRADING, EROSION CONTROL, & REMOVALS				DWG. No. C-01 REV. No. 0															

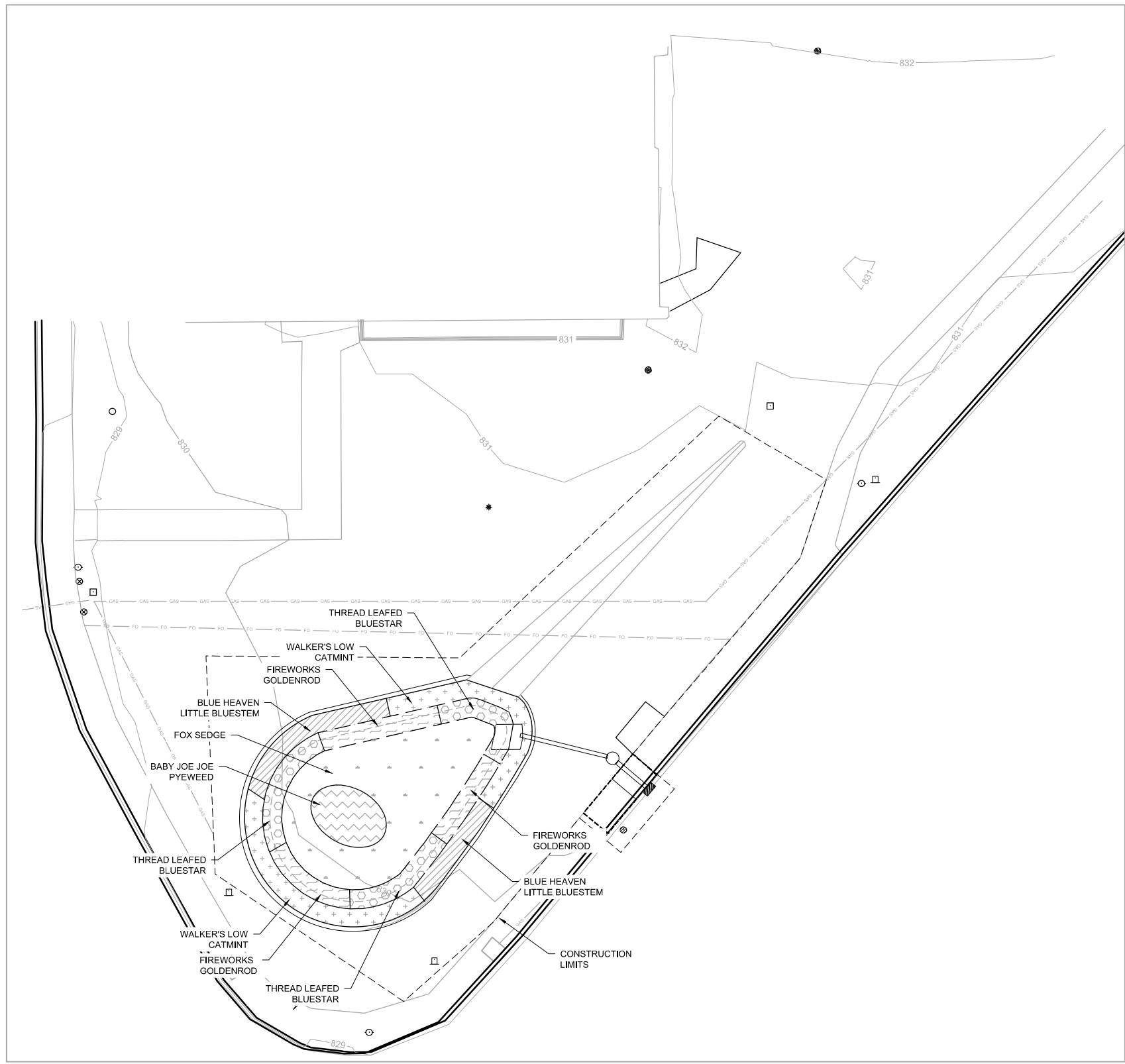

- SAND TRENCH
- POWER POLE
- LIGHT POLE
- SIGN POST
- DECIDUOUS TREE
- CONIFEROUS TREE
- SANITARY MANHOLE
- BACK OF CURB LINE
- FLOW LINE
- GAS LINE
- FIBER OPTIC LINE
- MAJOR CONTOUR 900
- MINOR CONTOUR 901
- PROPOSED MAJOR CONTOUR 900
- PROPOSED MINOR CONTOUR 901

PLANTING NOTES:

1. POTHOLE ALL EXISTING UTILITIES WITHIN THE PROJECT LIMITS BEFORE EARTHWORK BEGINS.
2. INFORM THE LANDSCAPE ARCHITECT OF PLANTING TWO DAYS PRIOR TO PLANT DELIVERY.
3. CONTRACTOR SHALL COORDINATE LAYOUT OF ALL PLANTS WITH DIRECTION OF LANDSCAPE ARCHITECT IN THE FIELD.
4. PLACE SHREDDED HARDWOOD MULCH (MN/DOT SPEC 3882.2 TYPE 6 - WEED SEED FREE SHREDDED HARDWOOD.) TO A DEPTH OF 3" WITHIN ALL PLANTING AREAS ONCE PLANT INSTALLATION IS COMPLETE.
5. INSTALL THE STEEL LANDSCAPE EDGING PER MANUFACTURER RECOMMENDATION INCLUDING STAKING SPACING AND QUANTITY.
6. CONTRACTOR WILL BE RESPONSIBLE FOR WATERING PLANTS (REGARDLESS OF NOTIFICATION) DURING ENTIRE WARRANTY PERIOD. WATERING WILL BE CONSIDERED INCIDENTAL TO THE CONTRACT.
7. ALL EXISTING CONCRETE, ASPHALT, TREES TO BE KEPT AND TREE ROOTS SHALL BE PROTECTED. ANY DAMAGE TO EXISTING SITE FEATURES SHALL BE CORRECTED AT THE CONTRACTOR'S EXPENSE AND TO THE OWNER'S SATISFACTION.
8. DAMAGE TO EXISTING STRUCTURES OR NEWLY CONSTRUCTED ITEMS SHALL BE REPAIRED AT CONTRACTOR'S EXPENSE TO THE SATISFACTION OF THE OWNER.
9. REFER TO SPECIFICATIONS FOR ADDITIONAL INFORMATION. IN THE CASE OF ANY DISCREPANCIES BETWEEN THIS DETAIL, PLANS, OR SPECIFICATIONS, THE SPECIFICATIONS SHALL GOVERN.

1 PLAN: RAIN GARDEN PLANTING

0 10 20
SCALE IN FEET

PRELIMINARY
DRAFT

CADD USER: Bill M. Brohman FILE: I:\DESIGN\23270634\002018\OAK GROVE\23270634.dwg PLOT SCALE: 1:2 PLOT DATE: 9/28/2018 10:07 AM
 BARR:\AutoCAD\2011\AutoCAD 2011 Support\enu\Template\Barr_2011_Template.dwt Plot at 1:10/25/2010 14:03:50

I HEREBY CERTIFY THAT THIS PLAN, SPECIFICATION, OR REPORT WAS PREPARED BY ME OR UNDER MY DIRECT SUPERVISION AND THAT I AM A DULY LICENSED LANDSCAPE ARCHITECT UNDER THE LAWS OF THE STATE OF MINNESOTA. PRINTED NAME: _____ SIGNATURE: _____ DATE: _____ LICENSE # _____		CLIENT BID CONSTRUCTION		RELEASED TO/FOR A B C 0 1 2 3		DATE RELEASED		 Project Office: BARR ENGINEERING CO. 4300 MARKETPOINTE DRIVE Suite 200 MINNEAPOLIS, MN 55435 Corporate Headquarters: Minneapolis, Minnesota Ph: 1-800-632-2277 Fax: (952) 832-2601 Ph: 1-800-632-2277 www.barr.com	Scale AS SHOWN Date 9/28/2018 Drawn WMB Checked _____ Designed WMB Approved _____		NINE MILE CREEK WATERSHED DISTRICT EDEN PRAIRIE, MN		OAK GROVE PRESBYTERIAN CHURCH BLOOMINGTON, MN		BARR PROJECT No. 2327634.00	
		NO. BY CHK. APP. DATE REVISION DESCRIPTION		NO. BY CHK. APP. DATE REVISION DESCRIPTION		NO. BY CHK. APP. DATE REVISION DESCRIPTION			NO. BY CHK. APP. DATE REVISION DESCRIPTION		NO. BY CHK. APP. DATE REVISION DESCRIPTION		CLIENT PROJECT No.		DWG. No. C-01 REV. No. 0	